

New Jersey Semi-Conductor Products, Inc.

20 STERN AVE.
SPRINGFIELD, NEW JERSEY 07081
U.S.A.

TELEPHONE: (973) 376-2922
(212) 227-8005
FAX: (973) 376-8860

Device No.	Package No.	V _{RRM} V Min	I _R nA Max	V _R V	V _F V		I _F mA	C pF Max	t _{rr} ns Max	Test Cond.	Proc. No.
					Min	Max					
1N3070	DO-35	200	100	175		1.0	100	5.0	50	(Note 1)	D1
1N4938	DO-35	200	100	175		1.0	100	5.0	50	(Note 1)	D1
BAV19	DO-35	120	100	100		1.0	100	5.0	50	(Note 2)	D1
BAV20	DO-35	200	100	150		1.0	100	5.0	50	(Note 2)	D1
BAV21	DO-35	250	100	200		1.0	100	5.0	50	(Note 2)	D1
BAX17	DO-35	200				1-2	200	10	120	(Note 2)	D1
BAY72	DO-35	125	100	100	0.51 0.63 0.73 0.78	0.64 0.78 0.92 1.0	1.0 10.0 50.0 100.0	5.0	50	(Note 3)	D1
BAY80	DO-35	150	100	120		1.0	150	6.0	60	(Note 3)	D1
FDH400	DO-35	200	100	150		1.1	300	2.0	50	(Note 4)	D1
FDH444	DO-35	150	50	100		1.2	300	2.5	60	(Note 4)	D1

Note 1: I_F = I_R = 30 mA, R_L = 100Ω.

Note 2: I_F = 30 mA, I_R = 30 mA, R_L = 100Ω. Recovery to I_R = 3 mA.

Note 3: I_F = I_R = 30 mA, R_L = 75Ω.

Note 4: I_F = 30 mA, R_L = 100Ω, I_{rr} = 30 mA.

DO-35

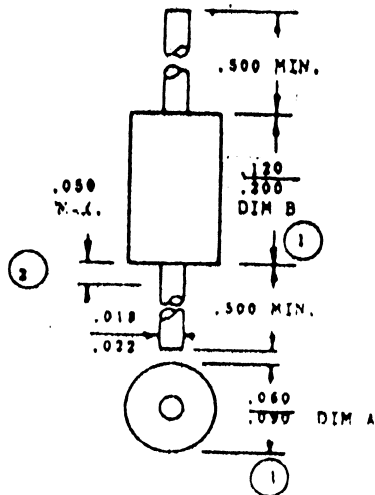

1. PACKAGE CONTOUR OPTIONAL WITHIN DIMENSIONS A & B. SLUGS, IF ANY, SHALL BE INCLUDED WITHIN THIS CYLINDER BUT SHALL NOT BE SUBJECT TO THE MINIMUM LIMIT OF DIM. A.
2. LEAD DIAMETER NOT CONTROLLED IN THIS ZONE TO ALLOW FOR PLASH, LEAD FINISH BUILD-UP, AND MINOR IRREGULARITIES OTHER THAN SLUGS.

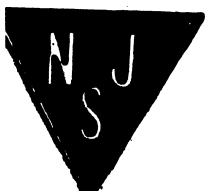

NJ Semi-Conductors reserves the right to change test conditions, parameter limits and package dimensions without notice. Information furnished by NJ Semi-Conductors is believed to be both accurate and reliable at the time of going to press. However NJ Semi-Conductors assumes no responsibility for any errors or omissions discovered in its use. NJ Semi-Conductors encourages customers to verify that datasheets are current before placing orders.